

• Double Inlet / Single Fan



Double Inlet/Single Fan—Industrial Class Evaporative Cooling Equipment with Capacities of 30,000 CFM to 80,000 CFM and up to 1.5" ESP or higher if required

Why?

Cel-Air® units are high capacity, high efficiency evaporative cooling equipment. With 24 cataloged units and sizes ranging from 6,000 CFM to over 100,000 CFM, United Metal Products gives the engineer, contractor, or owner the choice and options they want.

Benefits:

- 24 cataloged sizes
- 2" double wall or single wall construction
- Galvanized, aluminum, stainless steel
- 6,000–100,000 CFM and above
- Evaporative cooling
- Forward curve, airfoil, or backward inclined wheels
- ETL labeling available
- Powder coated
- Stainless steel reservoir available

Applications:

- Aircraft hangars
- Clean room M.U.A.
- Data centers
- Food processing plants
- Gymnasiums
- Hospitals
- Kitchens
- Make up air requirement
- Manufacturing facilities
- Military bases
- Mining industry
- Municipalities
- Prisons
- Process cooling
- Schools
- Textile industries
- Turbine inlet cooling
- Waste water treatment facility
- Warehouses

Resources Available for This Product

- Catalog By Mail
- Catalog Online



United Metal Products

1920 E Broadway Road Tempe, AZ 85282
T 480.968.9550
F 480.968.9555
www.unitedmetal.com

| MODEL # Air Volume | | DOUBLE INLET / SINGLE FAN - EXTERNAL STATIC PRESSURE ("WG) | | | | | | | | | | | | | | Power Requirements (at 460/3/60) * | | | |
|---------------------------|---------|--|----|------|----|------|----|------|----|------|----|------|----|------|----|------------------------------------|-----|-------------|-------------|
| | | WITHOUT FILTERS | | 0.25 | | 0.50 | | 0.75 | | 1.00 | | 1.25 | | 1.50 | | 1.75 | | MCA Amps | MOP Amps |
| | | WITH FILTERS | | FAN | HP | FAN | HP | FAN | HP | FAN | HP | FAN | HP | FAN | HP | FAN | HP | | |
| CEL-ODO-60 30,000 cfm | DWDI FC | 32 | 15 | 32 | 15 | 32 | 20 | 32 | 20 | 32 | 20 | 32 | 25 | 32 | 25 | 47 | 50 | | |
| | DWDI BI | 40 | 10 | 40 | 15 | 40 | 15 | 40 | 15 | 40 | 15 | 40 | 20 | 40 | 20 | 39 | 40 | | |
| | DWDI AF | | | | | | | 40 | 15 | 40 | 15 | 40 | 20 | 40 | 20 | 39 | 40 | | |
| CEL-ODO-72 36,000 cfm | DWDI FC | 40 | 15 | 40 | 15 | 40 | 20 | 40 | 20 | 40 | 20 | 40 | 25 | 40 | 25 | 47 | 50 | | |
| | DWDI BI | 40 | 15 | 40 | 15 | 40 | 20 | 40 | 20 | 40 | 20 | 40 | 25 | 40 | 25 | 47 | 50 | | |
| | DWDI AF | | | | | | | | | | | | | 40 | 25 | 47 | 50 | | |
| CEL-ODO-84 42,000 cfm | DWDI FC | 40 | 20 | 40 | 20 | 40 | 25 | 40 | 25 | 40 | 25 | 40 | 30 | 40 | 30 | 55 | 60 | | |
| | DWDI BI | 40 | 20 | 40 | 20 | 40 | 25 | 40 | 25 | 40 | 25 | 40 | 30 | 40 | 30 | 55 | 60 | | |
| | DWDI AF | | | | | | | | | | | | | | | | | | |
| CEL-ODO-96 48,000 cfm | DWDI FC | 40 | 25 | 40 | 25 | 40 | 30 | 40 | 30 | 40 | 40 | 40 | 40 | 40 | 40 | 70 | 80 | | |
| | DWDI BI | 40 | 30 | 40 | 30 | 40 | 30 | 40 | 40 | 40 | 40 | 40 | 40 | 40 | 40 | 70 | 80 | | |
| | DWDI AF | 36 | 30 | 36 | 30 | 36 | 40 | 36 | 40 | 36 | 40 | 36 | 40 | 36 | 40 | 70 | 80 | | |
| CEL-ODO-112 56,000 cfm | DWDI FC | 40 | 40 | 40 | 40 | 40 | 50 | 40 | 50 | 40 | 50 | 40 | 50 | 40 | 60 | 101 | 125 | | |
| | DWDI BI | 40 | 50 | 40 | 50 | 40 | 50 | 40 | 50 | 40 | 50 | 40 | 60 | 36 | 75 | 117 | 125 | | |
| | DWDI AF | 40 | 30 | 40 | 40 | 40 | 40 | 40 | 40 | 40 | 40 | 40 | 50 | 40 | 50 | 86 | 90 | | |
| CEL-ODO-140 70,000 cfm | DWDI FC | | | | | | | | | | | | | | | | | | |
| | DWDI BI | 49 | 40 | 49 | 40 | 49 | 40 | 49 | 50 | 49 | 50 | 49 | 50 | 49 | 50 | 86 | 90 | | |
| | DWDI AF | 49 | 40 | 49 | 40 | 49 | 40 | 49 | 40 | 49 | 40 | 49 | 50 | 49 | 50 | 86 | 90 | | |
| CEL-ODO-160 80,000 cfm | DWDI FC | | | | | | | | | | | | | | | | | | |
| | DWDI BI | 49 | 50 | 49 | 60 | 49 | 60 | 49 | 60 | 49 | 75 | 49 | 75 | 49 | 75 | 117 | 125 | | |
| | DWDI AF | 49 | 50 | 49 | 50 | 49 | 50 | 49 | 60 | 49 | 60 | 49 | 60 | 49 | 60 | 102 | 125 | | |

- * Unit power requirements, dimensions and weights are given as a guide. They include down discharge AF fans and the largest motor HP shown. Motors are standard efficiency single speed ODP.
- * Different fan or motor types, fan orientation or motor position will effect dimensions and weights. Full details will be given with any quotation.
- * All these units can operate at higher static pressures with fan or motor changes. Please contact the factory with your requirements.
- * Data is based on the maximum output of each unit size. Intermediate volumes will be achieved by reducing the fan speed.
- * Data shown is based at sea level. HP and performance may be effected at high altitudes.
- * The filter is an option. When adding filters, add the filter pressure drop to the unit ESP and use that total to select the motor HP.
- * Please specify the fan discharge location (Up, Down or End) when ordering these units.

| | | DOUBLE INLET / SINGLE FAN - EVAPORATIVE COOLER DIMENSIONS - See Drawing | | | | | | | | | | WEIGHTS | |
|---------------------------|-------------------|---|--------|--------|---|------|------|------|------|------|------|----------------------------------|---------------|
| MODEL # Air Volume | FAN QTY & TYPE | WIDTH | HEIGHT | LENGTH | A | B | C | D | E1 | E2 | F | With Clean Filters Ship lb | Operate lb |
| CEL-ODO-60 30,000 cfm | DWDI FC | 102 | 93 | 182 | 6 | 23.9 | 39.7 | 39.7 | 71.2 | 71.2 | 31.6 | 5,275 | 6,225 |
| | DWDI BI | 102 | 93 | 182 | 6 | 27.0 | 49.9 | 49.9 | 66.1 | 66.1 | 34.8 | 5,575 | 6,550 |
| | DWDI AF | 102 | 93 | 182 | 6 | 27.0 | 49.9 | 49.9 | 66.1 | 66.1 | 34.8 | 5,550 | 6,500 |
| CEL-ODO-72 36,000 cfm | DWDI FC | 107 | 96 | 182 | 6 | 27.0 | 49.9 | 49.9 | 66.1 | 66.1 | 34.8 | 5,800 | 6,800 |
| | DWDI BI | 107 | 96 | 182 | 6 | 27.0 | 49.9 | 49.9 | 66.1 | 66.1 | 34.8 | 5,900 | 6,925 |
| | DWDI AF | 107 | 96 | 182 | 6 | 27.0 | 49.9 | 49.9 | 66.1 | 66.1 | 34.8 | 5,925 | 6,925 |
| CEL-ODO-84 42,000 cfm | DWDI FC | 107 | 96 | 182 | 6 | 27.0 | 49.9 | 49.9 | 66.1 | 66.1 | 34.8 | 5,875 | 7,050 |
| | DWDI BI | 107 | 96 | 182 | 6 | 27.0 | 49.9 | 49.9 | 66.1 | 66.1 | 34.8 | 5,975 | 7,125 |
| | DWDI AF | | | | | | | | | | | | |
| CEL-ODO-96 48,000 cfm | DWDI FC | 110 | 96 | 182 | 6 | 27.0 | 49.9 | 49.9 | 66.1 | 66.1 | 34.8 | 6,075 | 7,400 |
| | DWDI BI | 110 | 96 | 182 | 6 | 27.0 | 49.9 | 49.9 | 66.1 | 66.1 | 34.8 | 6,150 | 7,475 |
| | DWDI AF | 110 | 96 | 182 | 6 | 35.2 | 51.8 | 38.7 | 65.1 | 65.1 | 37.2 | 6,850 | 8,175 |
| CEL-ODO-112 56,000 cfm | DWDI FC | 114 | 108 | 192 | 6 | 27.0 | 49.9 | 49.9 | 71.1 | 71.1 | 36.8 | 6,900 | 8,275 |
| | DWDI BI | 114 | 108 | 192 | 6 | 26.1 | 49.9 | 49.9 | 71.1 | 71.1 | 35.9 | 6,800 | 8,200 |
| | DWDI AF | 114 | 108 | 192 | 6 | 38.0 | 57.2 | 42.6 | 67.4 | 67.4 | 46.7 | 7,775 | 9,150 |
| CEL-ODO-140 70,000 cfm | DWDI FC | | | | | | | | | | | | |
| | DWDI BI | 132 | 112 | 209 | 6 | 45.1 | 69.4 | 51.9 | 69.8 | 69.8 | 52.7 | 9,550 | 11,250 |
| | DWDI AF | 132 | 112 | 209 | 6 | 45.1 | 69.4 | 51.9 | 69.8 | 69.8 | 52.7 | 9,550 | 11,250 |
| CEL-ODO-160 80,000 cfm | DWDI FC | | | | | | | | | | | | |
| | DWDI BI | 133 | 120 | 209 | 6 | 45.1 | 69.4 | 51.9 | 69.8 | 69.8 | 52.7 | 10,050 | 11,825 |
| | DWDI AF | 133 | 120 | 209 | 6 | 45.1 | 69.4 | 51.9 | 69.8 | 69.8 | 52.7 | 9,925 | 11,700 |

- * Unit height shown above includes the standing roof seam.
- * Allow a minimum service clearance of 36" in front of all access doors and air inlet louvers.
- * We recommend a minimum incoming water line pressure of 50 psi. Under no circumstances should the incoming water line pressure exceed 125psi.
- * Standard Evaporative Media access panels require (2) persons to lift on units over 72" high. Consider upgrading to hinged access doors on tall units.
- * Due to continued product development, all data is subject to change without notice. Full details will be provided with submittals.

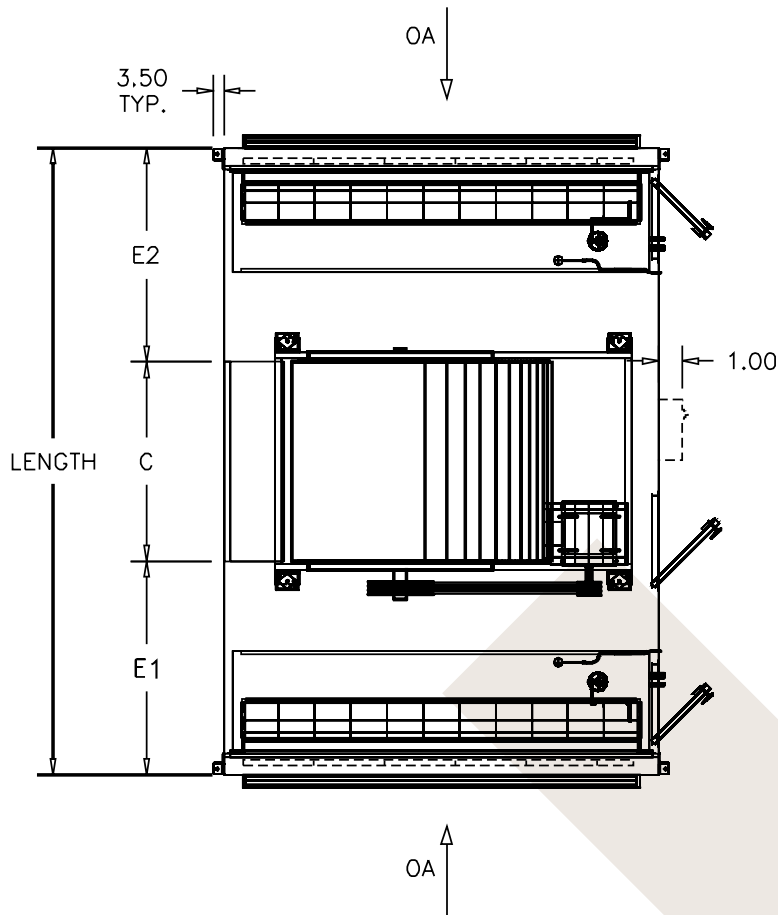

OUTSIDE CURB DIMENSIONS

Deduct 5.0" from the O.D. of the baseframe to obtain the O.D. of the roof curb. Please check submittal drawings to verify exact O.D. of the baseframe before the roof curb is built.

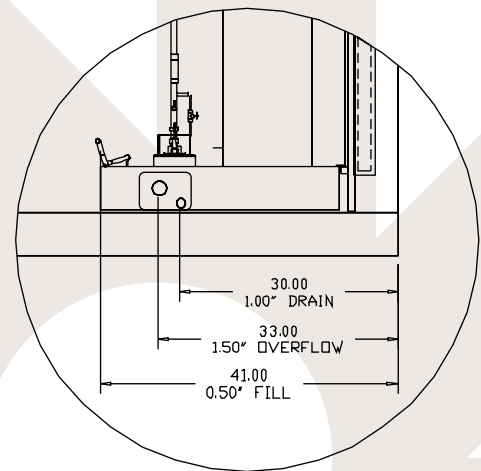
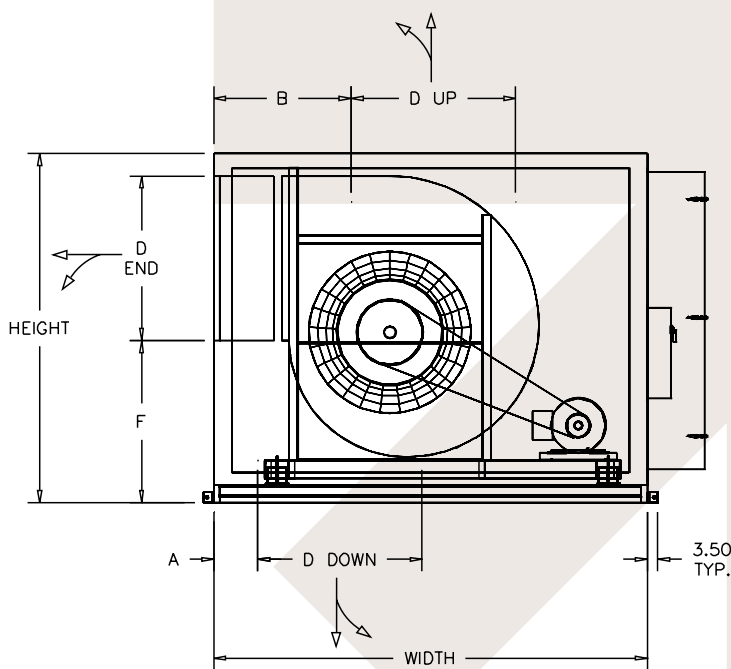

COPPER PLUMBING LOCATION DETAIL